

# EDDY'S AUTO CENTER

6845 HWY 10, RAMSEY, MN 55303

FOR SALE

17,500 SF ON 4 ACRES



## PROPERTY DETAILS

FOR SALE: ~~\$1,737,000.00~~

**REDUCED PRICE: \$1,500,000.00**

- 120 - 160 PARKING STALLS
- 17,500 SF BUILDING ON 4 ACRES
- CURRENTLY USED FOR AUTOMOTIVE SALES, AUTO SERVICE AND AUTO BODY
- 12 DRIVE IN DOORS (14' TALL AND 12' TALL) POTENTIAL DOCK ACCESS
- PERMITS IN PLACE FOR AUTOMOTIVE USE WHICH STAY WITH THE PROPERTY
- GREAT VISABILITY ON HWY 10
- 1 MILE FROM RAMSEY TOWN CENTER



JEFF SALZBRUN  
612-788-1552  
jeffs@essencerealestate.com

JEFF NORDNESS  
651-341-5044  
jeff@essencerealestate.com

OFFICE: 651-482-1871

# ERSI

ESSENCE  
REAL ESTATE  
SERVICES INC.

COMMERCIAL REAL ESTATE SINCE 1990



# EDDY'S AUTO CENTER

6845 HWY 10, RAMSEY, MN 55303

FOR SALE

PHOTOS



JEFF SALZBRUN  
612-788-1552  
jeffs@essencerealestate.com

JEFF NORDNESS  
651-341-5044  
jeff@essencerealestate.com

OFFICE: 651-482-1871

# ERSI

ESSENCE  
REAL ESTATE  
SERVICES INC.

COMMERCIAL REAL ESTATE SINCE 1990



# EDDY'S AUTO CENTER

6845 HWY 10, RAMSEY, MN 55303

FOR SALE

FLOOR PLAN

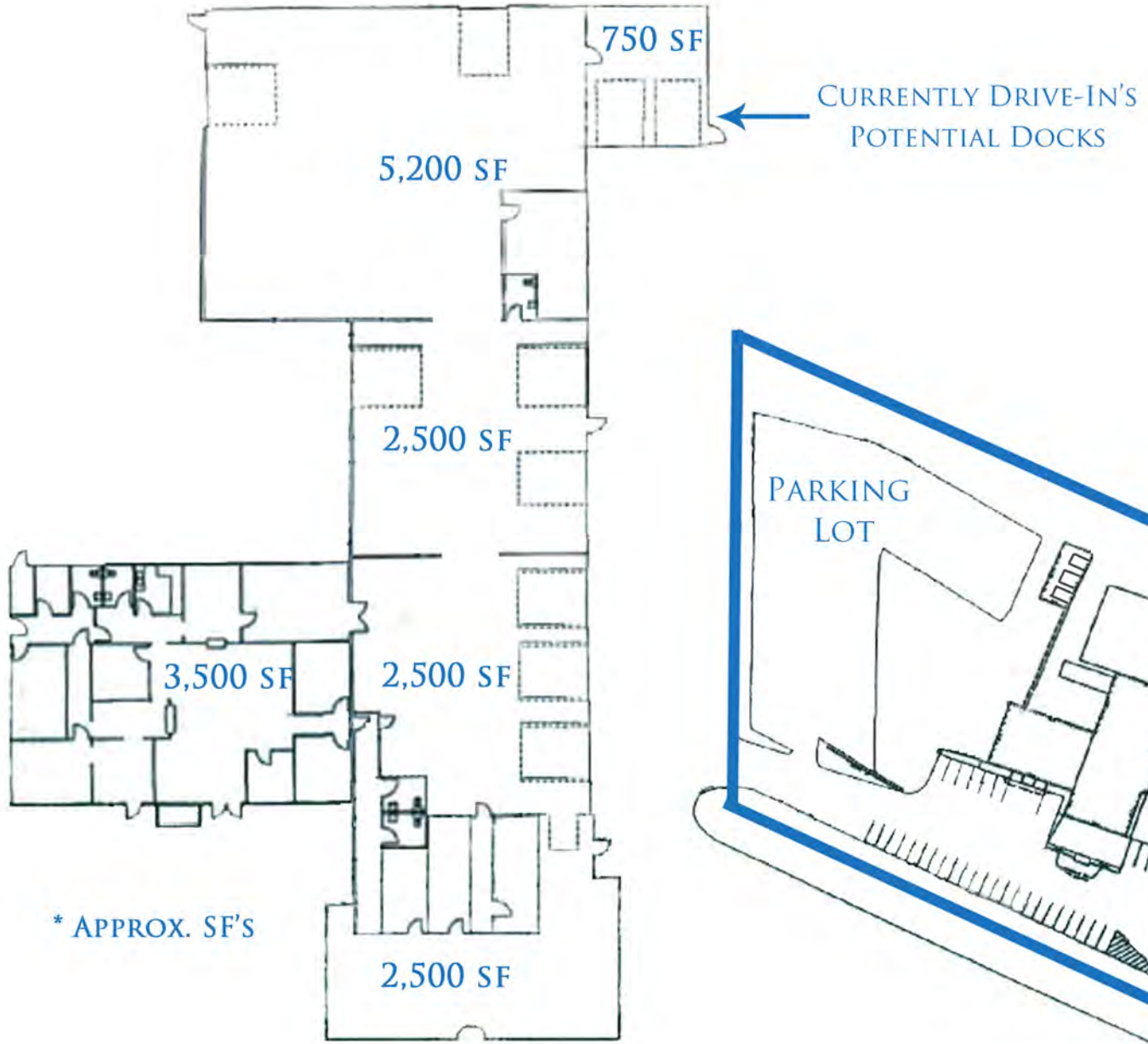

\* APPROX. SF'S

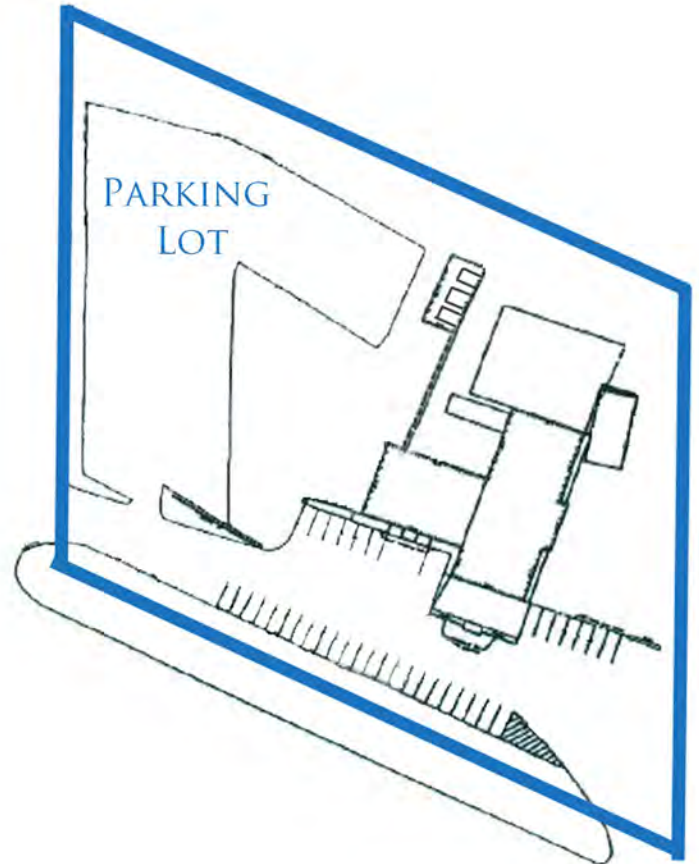

SITE PLAN  
4 ACRES

JEFF SALZBRUN  
612-788-1552  
jeffs@essencerealestate.com

JEFF NORDNESS  
651-341-5044  
jeff@essencerealestate.com

OFFICE: 651-482-1871

# ERSI

ESSENCE  
REAL ESTATE  
SERVICES INC.

COMMERCIAL REAL ESTATE SINCE 1990